

Scale 1:2

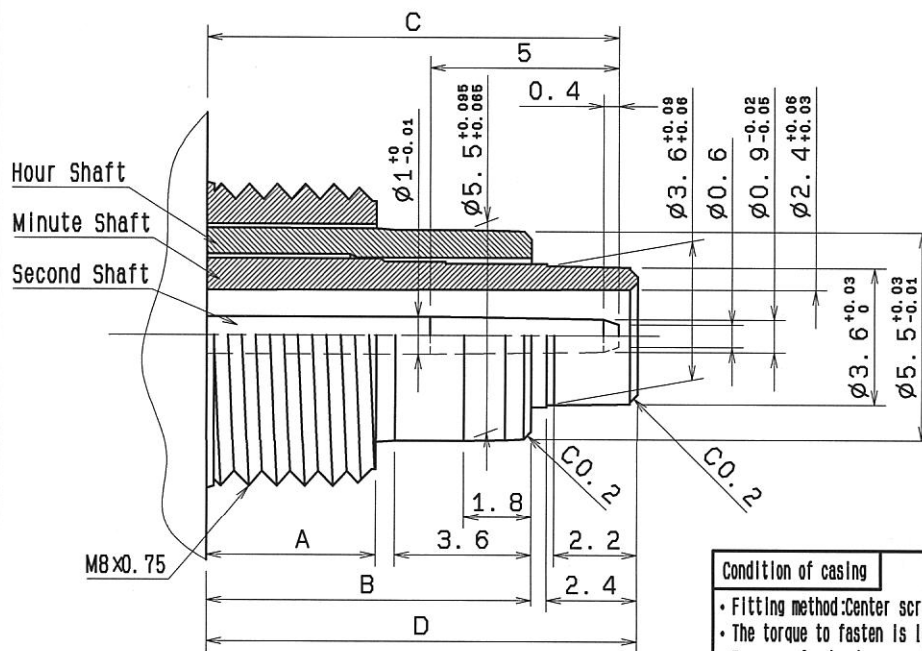
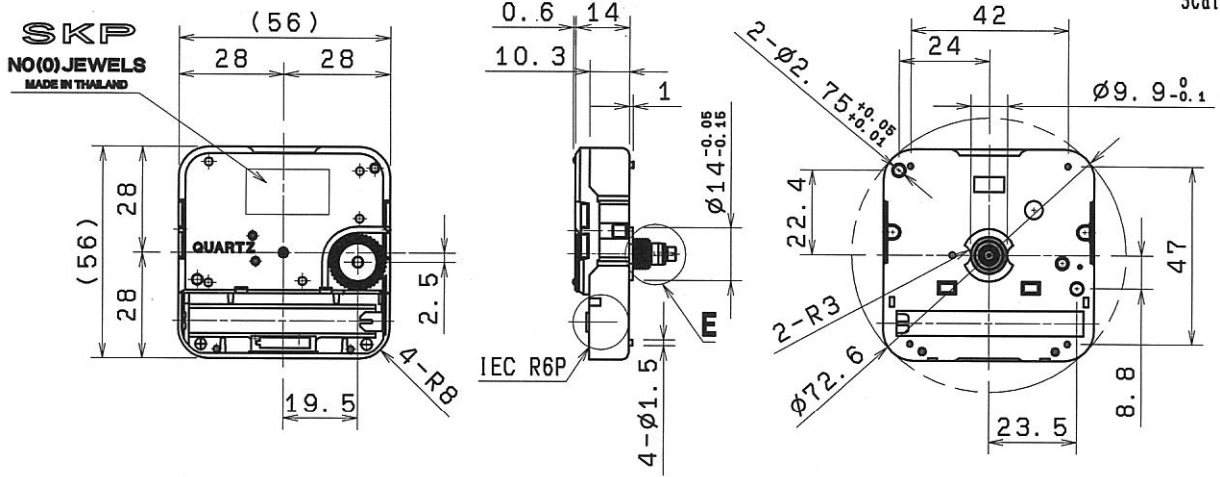

Detail of E (5:1)

Made In SEIKO Factory (Thailand)

CAL.	A:Center Screw	B:Hour Hand	C:Seconds Hand	D:Minute Hand
44704V	4.5	8.6	10.9	11.4
44704L (est)	4.5	8.6	10.9	11.4
44808V	8.8	12.6	15.2	15.4

(\*) There is no carving made in Thailand.

Indication	Hour, Minute and Seconds hand (sweep second)
Starting method	Self starting
Original governor	Crystal oscillator 32.768kHz
Accuracy of time	Average monthly rate : Within ±20sec.
Operating temperature	(-10~+50)°C
Operating voltage	(1.3~1.7)V
Average current	Less than 180 μA/1.5V, 23±3°C
Output torque	Seconds hand:More than 0.7×10 <sup>-4</sup> N·m(0.7gf·cm)/1.3V Minute Hand :More than 2.7×10 <sup>-4</sup> N·m(27gf·cm)/1.3V
Battery	(JIS IEC R6P) (SUM-3) 1.5V
Battery life	About 1 year

Condition of casing

- Fitting method:Center screw
- The torque to fasten is less than 1N·m(10 Kgf·cm)
- Pressure for hands press fitting : Less than 50N (5 kgf)
- [ Caution ] Support center of UPPER PLATE when fitting hands.
- Metal hands is as follows.
- ※ If you use plastic hands , please make dimensions smaller than below.

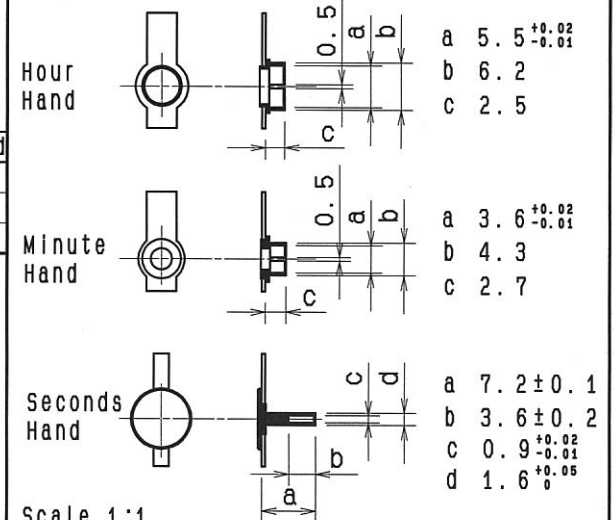

Scale 1:1

Condition	Unbalance N·m (gf·cm)	Weight (g)	Length from center (mm)
Seconds hand	Less than 1.5×10 <sup>-4</sup> (0.15)	Less than 2	Less than 130
Minute Hand	Less than 6×10 <sup>-4</sup> (6)	Less than 5	Less than 160
Hour hand	Less than 6×10 <sup>-4</sup> (6)	Less than 5	Less than 160